

RETAIL OPPORTUNITY AT REFUEL

CAMERON, NC

1,164 SF
FOR
LEASE



EXCLUSIVE LISTING BROKER

BRIAN GRABOWSKI

919.349.3569

BGRABOWSKI@TRADEMARKPROPERTIES.COM

1001 WADE AVENUE SUITE 300, RALEIGH, NC 27605

TRADEMARKPROPERTIES.COM | 919-782-5552



TRADEMARK
PROPERTIES

277 NC 24
CAMERON, NC 28326

PROPERTY HIGHLIGHTS

- 1,164 SF
- **Lease Rate: \$11.00 Gross Rent** (Landlord pays taxes, insurance, and maintenance)
- Serves the rural community of Johnsonville as well as commuters heading southbound to Spring Lake, Fayetteville and Fort Bragg- the country's largest military base
- Full access to NC 24 (8,900 AADT) and Hillbrook Drive
- Excellent visibility



277 NC 24
CAMERON, NC 28326



FLOOR PLAN

Ceiling height: 9.8'

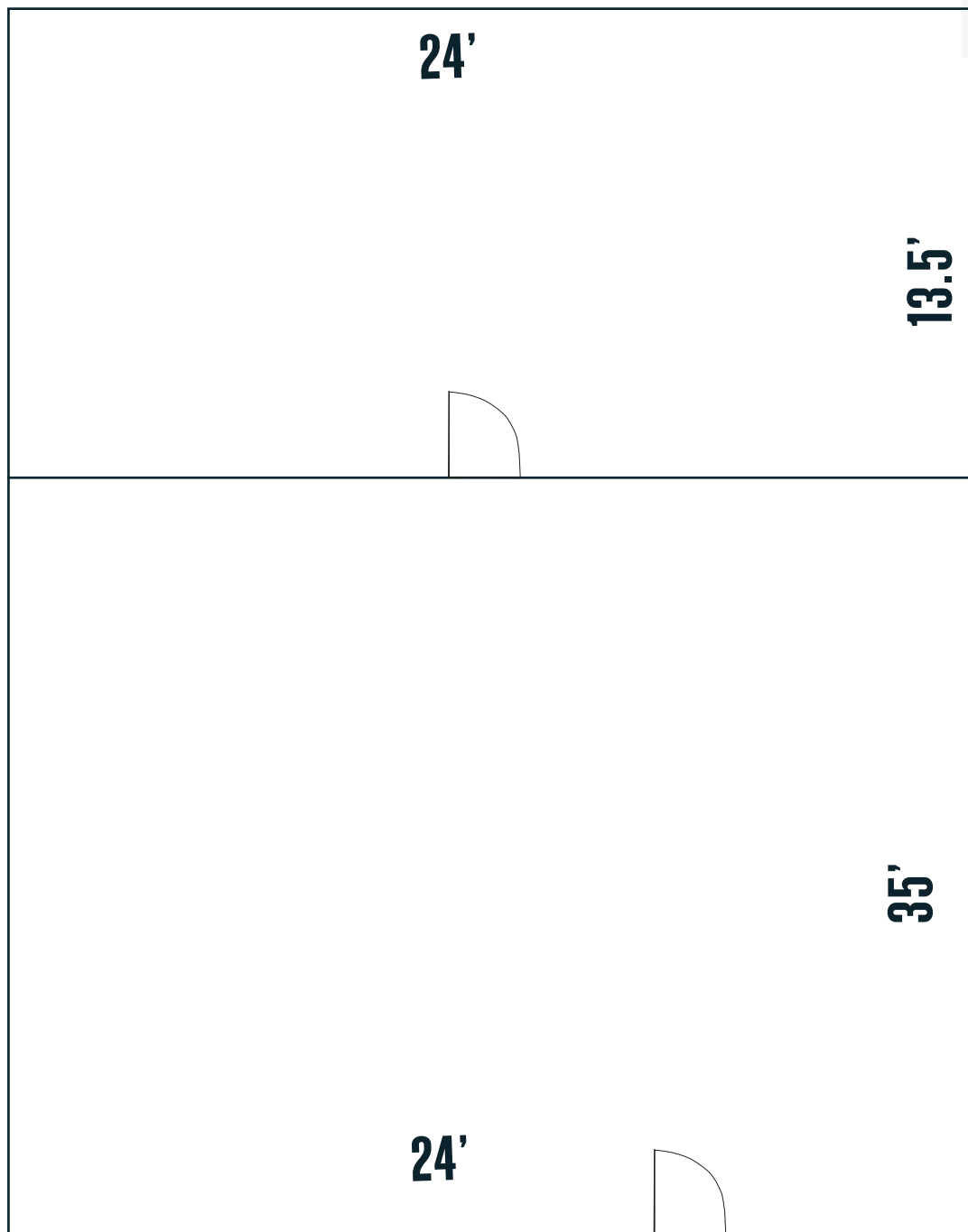

**Square Footage is correct based on available information.
Additional measurements may be warranted to ensure accuracy.*

277 NC 24
CAMERON, NC 28326

LOCATION MAP



277 NC 24
CAMERON, NC 28326

DEMOGRAPHICS

2022 POPULATION

| 1 MILE RADIUS | 3 MILE RADIUS | 5 MILE RADIUS |
|---------------|---------------|---------------|
| 1,393 | 9,364 | 32,649 |

AVG. HOUSEHOLD INCOME

| 1 MILE RADIUS | 3 MILE RADIUS | 5 MILE RADIUS |
|---------------|---------------|---------------|
| \$62,023 | \$69,349 | \$76,298 |

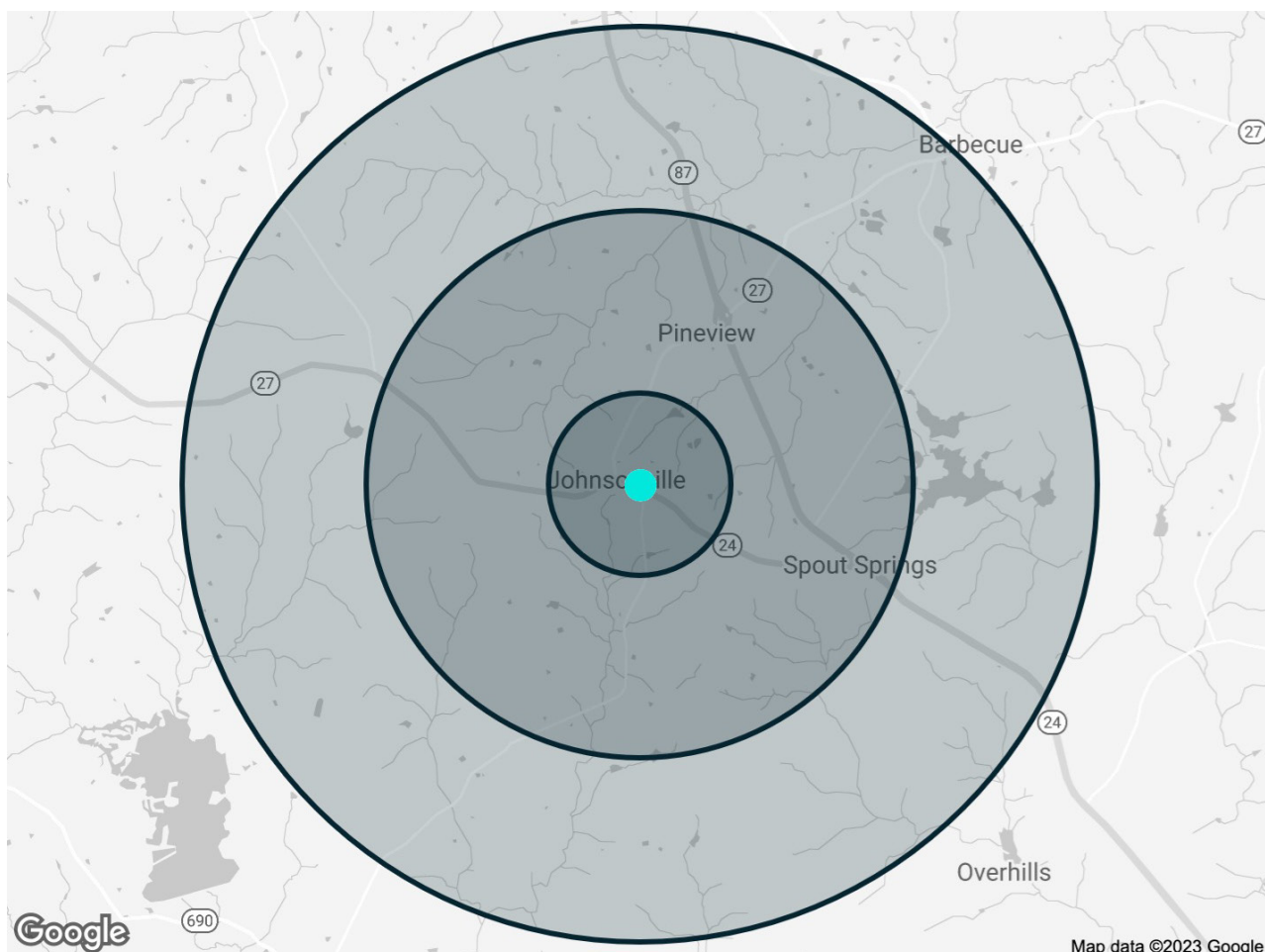

277 NC 24
CAMERON, NC 28326

ADDITIONAL OPPORTUNITIES

Cameron is a part of a five property portfolio with stores throughout central North Carolina.

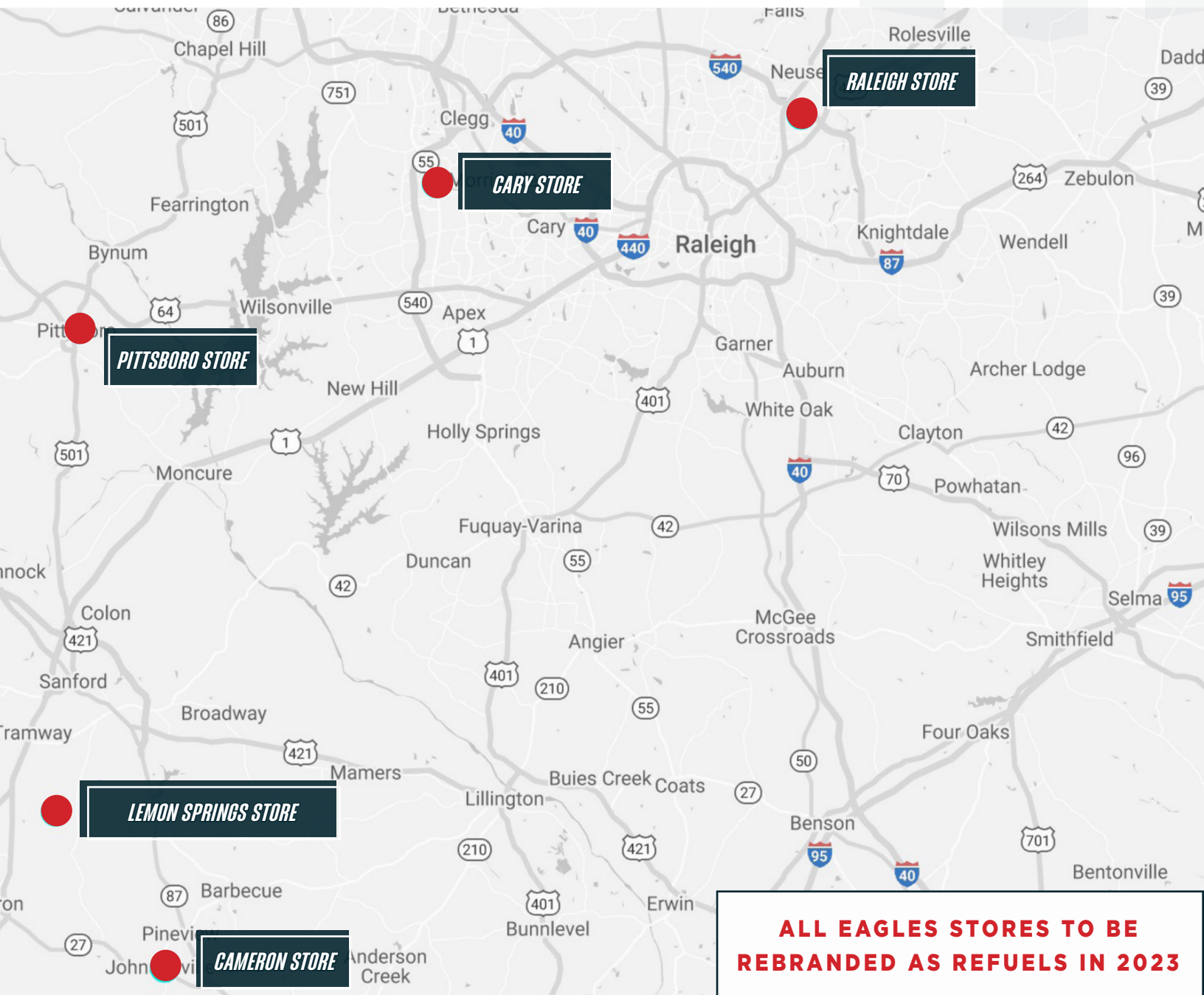



TRADEMARK
P R O P E R T I E S

BRIAN GRABOWSKI
919.349.3569 DIRECT
BGRABOWSKI@TRADEMARKPROPERTIES.COM

1001 WADE AVENUE SUITE 300
RALEIGH, NC 27605
TRADEMARKPROPERTIES.COM | 919-782-5552