



TRYON BUSINESS CENTER II

201 TRYON ROAD | RALEIGH, NC 27610

FOR LEASE

3,600 SF FLEX SPACE

LISTING BROKER:

DAN MCCLOY
919.227.5524 (O) | 919.270.9587 (M)
DMCCLOY@TRADEMARKPROPERTIES.COM



TRADEMARK
PROPERTIES

1001 WADE AVENUE SUITE 300, RALEIGH, NC 27605
TRADEMARKPROPERTIES.COM | 919-782-5552

201 TRYON ROAD
RALEIGH, NC 27603



PROPERTY HIGHLIGHTS



LEASE RATE:
\$16.95/SF, NNN
TICAM: \$4.41/SF

- » 12,000 SF flex building
- » Suite 115 available
 - » 3,600 SF
 - » Two Drive in Doors
 - » Fully Conditioned
- » Located on Tryon Road near S. Wilmington Street in Raleigh
- » 3:1,000 SF parking ratio
- » Single-story brick and glass facility
- » Exterior building signage
- » Highly visible from Tryon Road

DAN MCCLOY
919.227.5524 (O) | 919.270.9587 (M)
DMCCLOY@TRADEMARKPROPERTIES.COM

201 TRYON ROAD
RALEIGH, NC 27603



AERIAL MAP

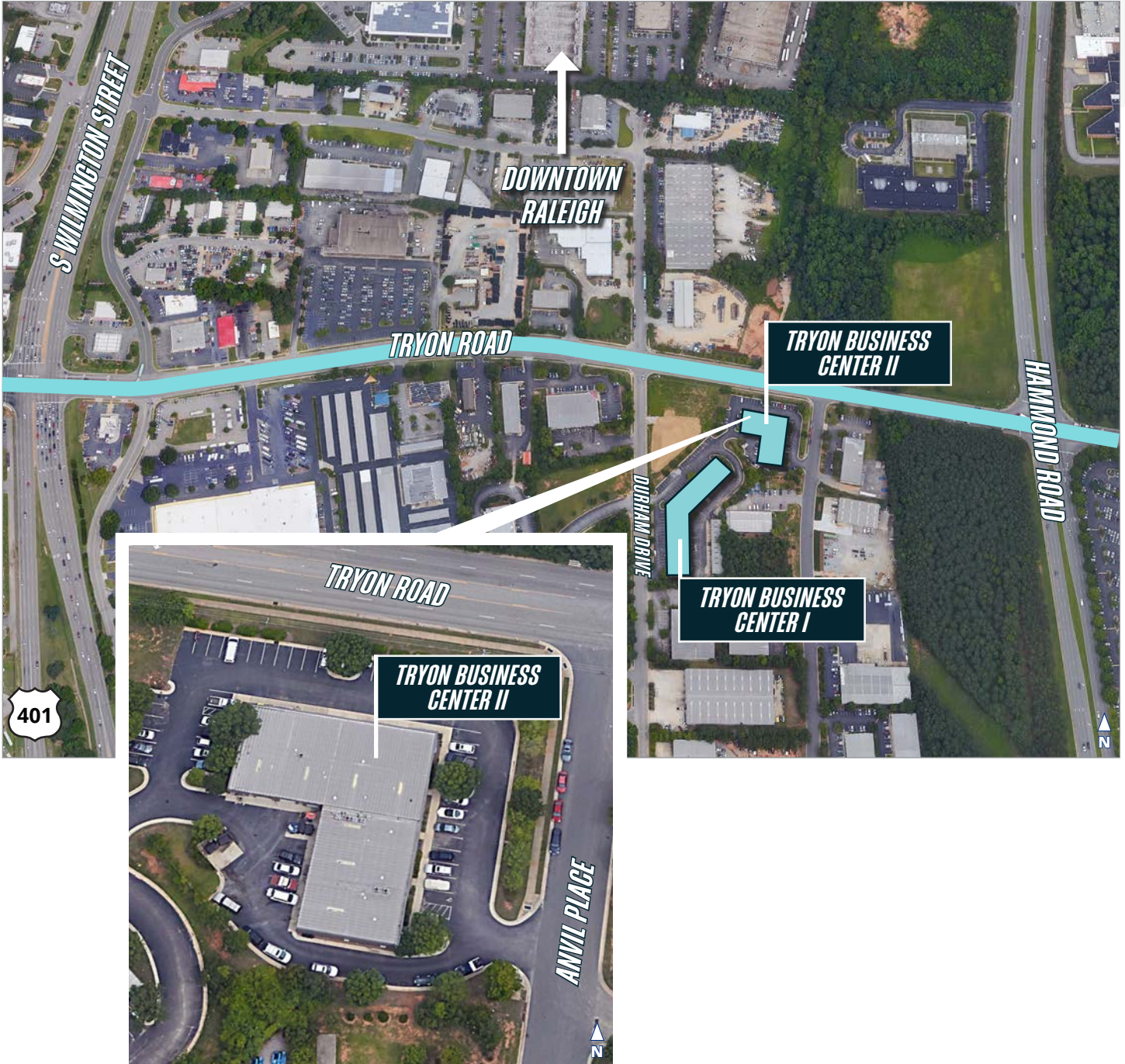

DAN MCCLOY
919.227.5524 (O) | 919.270.9587 (M)
DMCCLOY@TRADEMARKPROPERTIES.COM

FLOOR PLAN: SUITE 115

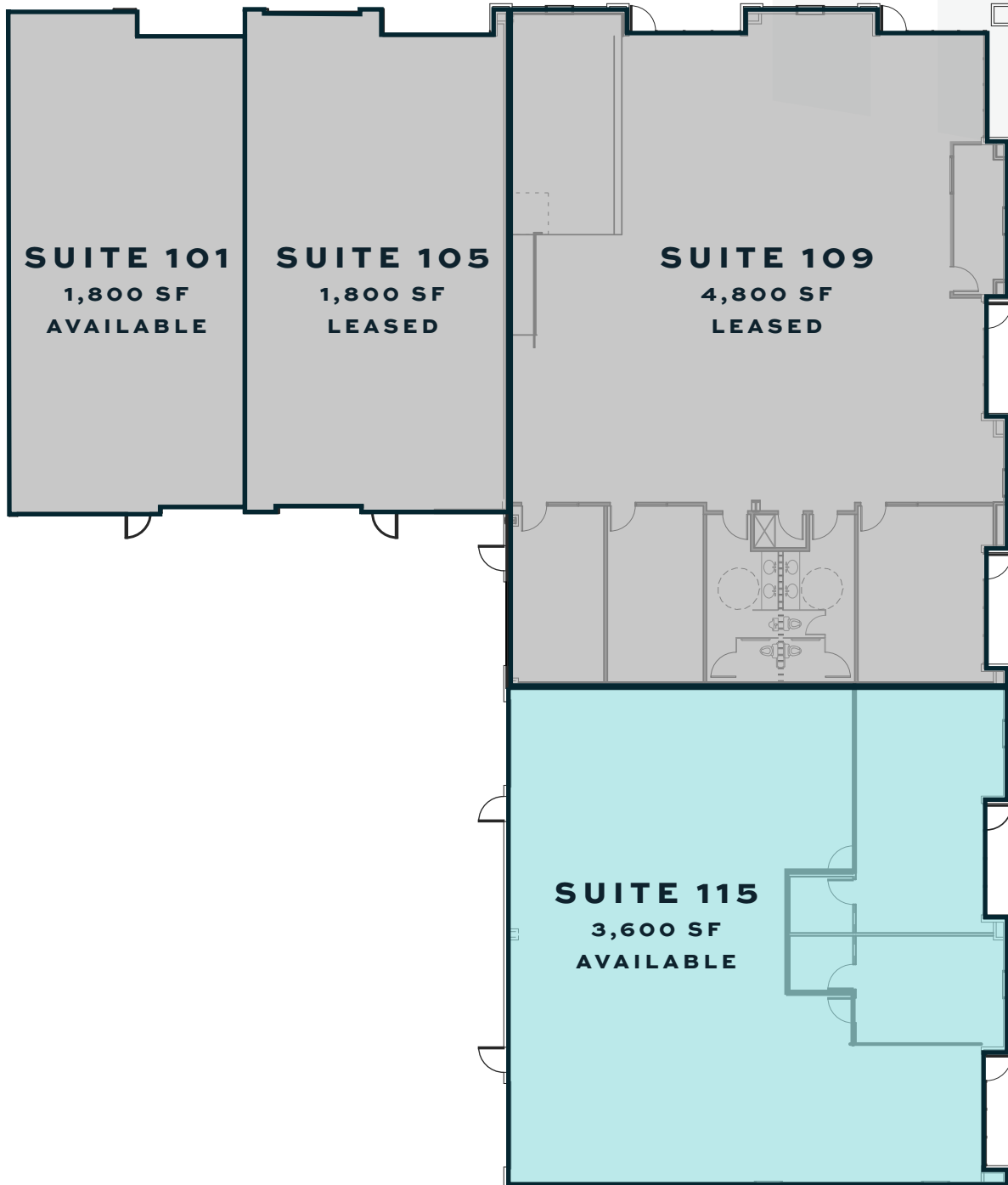

LISTING BROKER:

DAN MCCLOY

919.227.5524 DIRECT | 919.270.9587 MOBILE
DMCCLOY@TRADEMARKPROPERTIES.COM



TRADEMARK
PROPERTIES

THIS IS OUR TRADEMARK

THE INFORMATION CONTAINED HEREIN WAS OBTAINED FROM SOURCES BELIEVED RELIABLE; HOWEVER, TRADEMARK PROPERTIES MAKES NO GUARANTEES, WARRANTIES, OR REPRESENTATIONS AS TO THE COMPLETENESS OR ACCURACY THEREOF. THE PRESENTATION OF THIS PROPERTY IS SUBMITTED SUBJECT TO ERRORS, OMISSIONS, CHANGES OF PRICE OR CONDITIONS PRIOR TO SALE OR LEASE, OR WITHDRAWAL WITHOUT NOTICE.