



509 GURLEY'S MILL ROAD

PRINCETON, NC 27569

15,000 SF AVAILABLE



**DAN MCCLOY**

[dmccloy@trademarkproperties.com](mailto:dmccloy@trademarkproperties.com)

919.227.5524 direct 919.270.9587 mobile

1001 Wade Avenue, Suite 300, Raleigh, NC 27605  
[trademarkproperties.com](http://trademarkproperties.com) • 919.782.5552

# 509 GURLEY'S MILL ROAD

## PRINCETON, NC 27569

INDUSTRIAL SPACE FOR LEASE

### BUILDING DESCRIPTION

- 15,000 SF of warehouse space for lease
- 150' x 100' warehouse
- 25' x 50' columns
- Two drive-in doors - 16' x 16'
- One drive-in door - 12' x 16'
- Two 200-amp panels
- 208v three-phase power
- Warehouse only, space does not include office or bathroom but can be built out
- Dock access available or installation possible
- 2:1,000 SF parking

### LOCATION DESCRIPTION

- Located southeast of Raleigh in Johnston County along US-70 Highway (future I-42)
- Approximately 37 minutes to Raleigh City Limits
- Approximately 10 miles to I-95
- 10 miles to I-495



### ABOUT PRINCETON

- Incorporated in 1861 with an estimated population of 12
- Now has an estimated population of 1,260
- Located halfway between Smithfield and Goldsboro



LEASE RATE

**\$5.00/SF**

**MODIFIED GROSS**

### DAN MCCLOY

dmccloy@trademarkproperties.com  
919.227.5524 direct 919.270.9587 mobile

The information contained herein was obtained from sources believed reliable; however, TradeMark Properties makes no guarantees, warranties, or representations as to the completeness or accuracy thereof. The presentation of this property is submitted subject to errors, omissions, changes of price or conditions prior to sale or lease, or withdrawal without notice.



1001 Wade Avenue, Suite 300, Raleigh, NC 27605  
trademarkproperties.com • 919.782.5552

509 GURLEY'S MILL ROAD  
PRINCETON, NC 27569

INDUSTRIAL SPACE FOR LEASE

CONCEPTUAL FLOOR PLAN

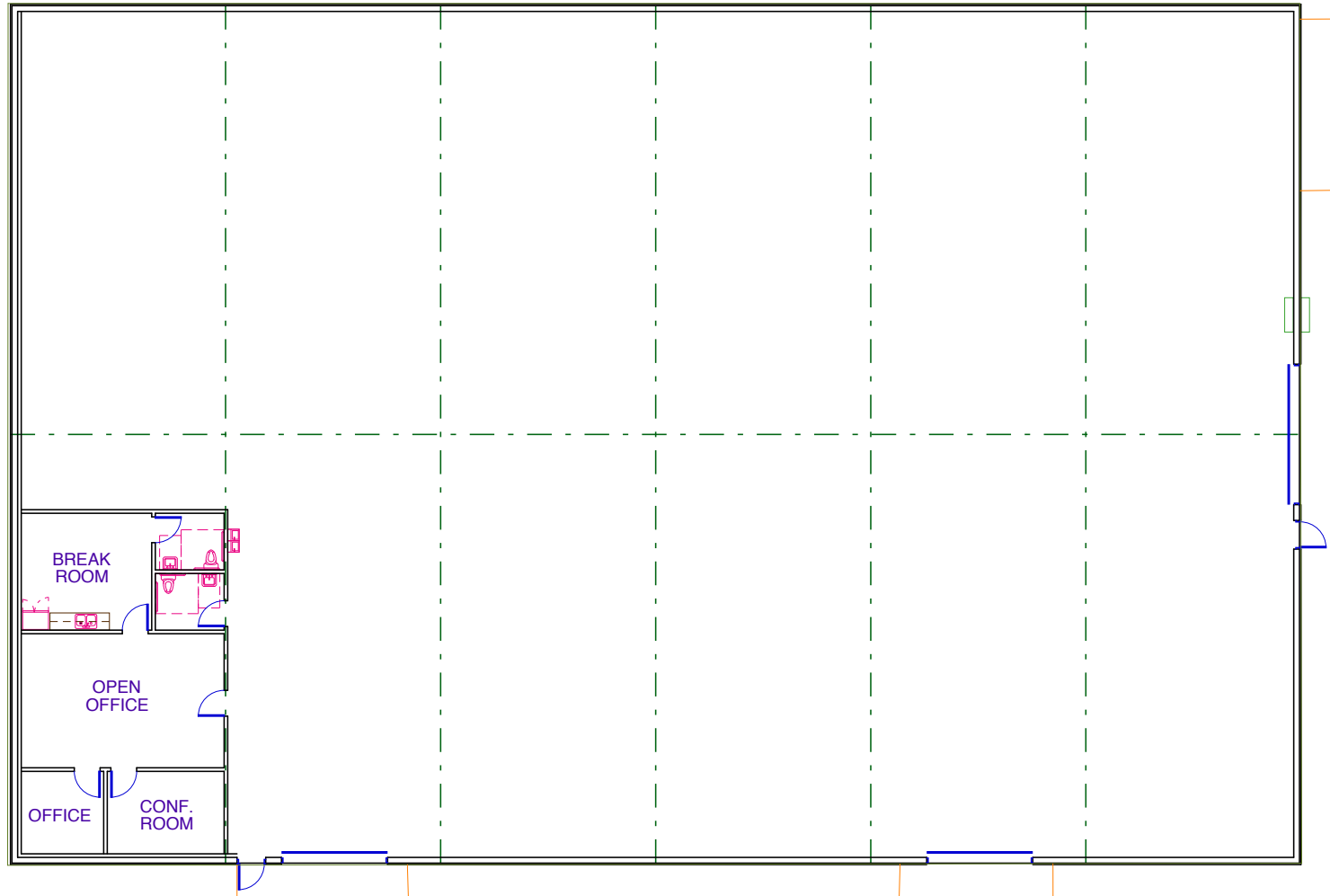

DAN MCCLOY

dmccloy@trademarkproperties.com

919.227.5524 direct 919.270.9587 mobile

The information contained herein was obtained from sources believed reliable; however, TradeMark Properties makes no guarantees, warranties, or representations as to the completeness or accuracy thereof. The presentation of this property is submitted subject to errors, omissions, changes of price or conditions prior to sale or lease, or withdrawal without notice.



1001 Wade Avenue, Suite 300, Raleigh, NC 27605  
trademarkproperties.com • 919.782.5552



509 GURLEY'S MILL ROAD  
PRINCETON, NC 27569

INDUSTRIAL SPACE FOR LEASE

LOCATION MAP



DAN MCCLOY

[dmccloy@trademarkproperties.com](mailto:dmccloy@trademarkproperties.com)

919.227.5524 direct 919.270.9587 mobile

The information contained herein was obtained from sources believed reliable; however, TradeMark Properties makes no guarantees, warranties, or representations as to the completeness or accuracy thereof. The presentation of this property is submitted subject to errors, omissions, changes of price or conditions prior to sale or lease, or withdrawal without notice.



1001 Wade Avenue, Suite 300, Raleigh, NC 27605  
[trademarkproperties.com](http://trademarkproperties.com) • 919.782.5552

# 509 GURLEY'S MILL ROAD PRINCETON, NC 27569

INDUSTRIAL SPACE FOR LEASE

## LOCATION MAP

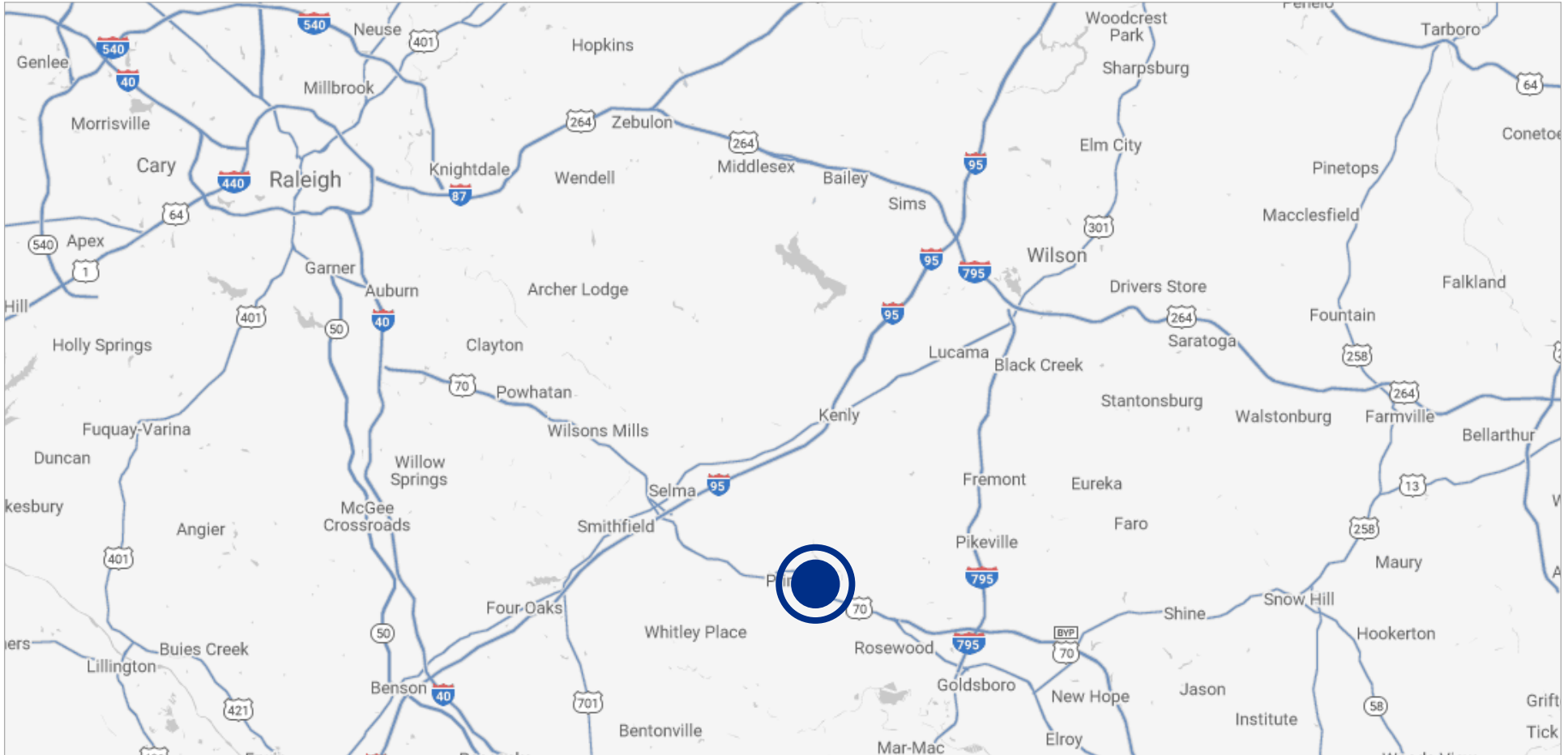

### DAN MCCLOY

[dmccloy@trademarkproperties.com](mailto:dmccloy@trademarkproperties.com)

919.227.5524 direct 919.270.9587 mobile

The information contained herein was obtained from sources believed reliable; however, TradeMark Properties makes no guarantees, warranties, or representations as to the completeness or accuracy thereof. The presentation of this property is submitted subject to errors, omissions, changes of price or conditions prior to sale or lease, or withdrawal without notice.



1001 Wade Avenue, Suite 300, Raleigh, NC 27605  
[trademarkproperties.com](http://trademarkproperties.com) • 919.782.5552